

! Pin screw for additional locking of the fiber ferrule:  
 - before pulling the FC-connector:  
 unlock the pin screw.  
 - before inserting the FC-connector:  
 make sure the ferrule receptacle is not blocked  
 by the pin screw !

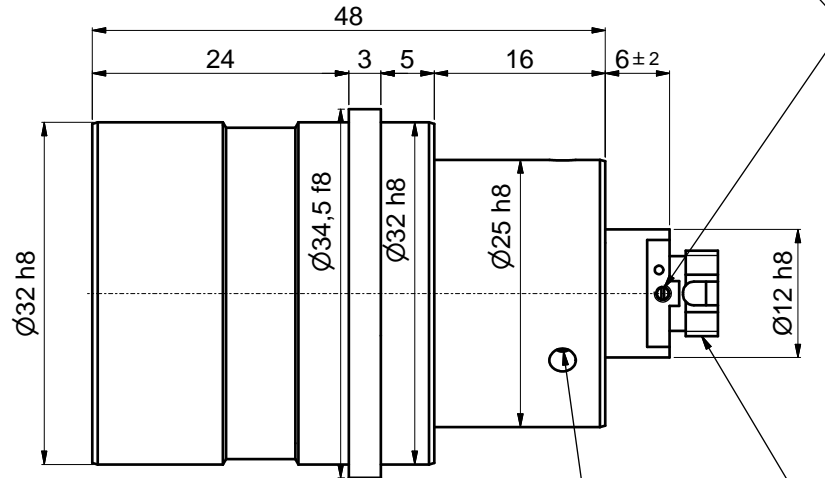

clamp screws for locking optics position (2x120°)  
 using hex-key size 1.5mm  
 50HD-15 ①

Fiber receptacle  
 type FC-PC  
 (wide key)

! Don't touch any other screws !

hex-key  
 size 1.5mm  
 50HD-15

screw driver  
 size 1.2mm  
 9D-12

①



②

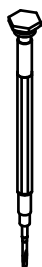

Allgemeintoleranz ISO 2768 - f		Maßstab: 2:1
60FC-L-0-M40L-xx		
Datum		Name
Bearb.	01.03.2017	Tp
Gepr.		
Norm		
Schäfter&Kirchhoff OPTO-SENSORIK UND MESSTECHNIK		Blatt A3
9802-4188-8600		Blatt: 2
Zust.	Änderungen	Datum
Datei: 980241888600.idw		Modell: 980241888600.iam