

Thrust and tension screw (3x120°)  
for tilt adjustment  
with hex key wrench size 1.5mm  
50HD-15 ①

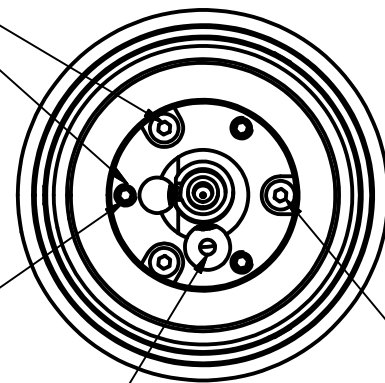

Thrust screw M3 max.torque 50Ncm

Tension screw M2 max.torque 40Ncm

Rotation of the quarter wave plate  
with adjustment key ④

! Pin screw for additional locking of the fiber ferrule:  
- before pulling the FC-connector:  
unlock the pin screw.  
- before inserting the FC-connector:  
make sure the ferrule receptacle is not blocked  
by the pin screw !

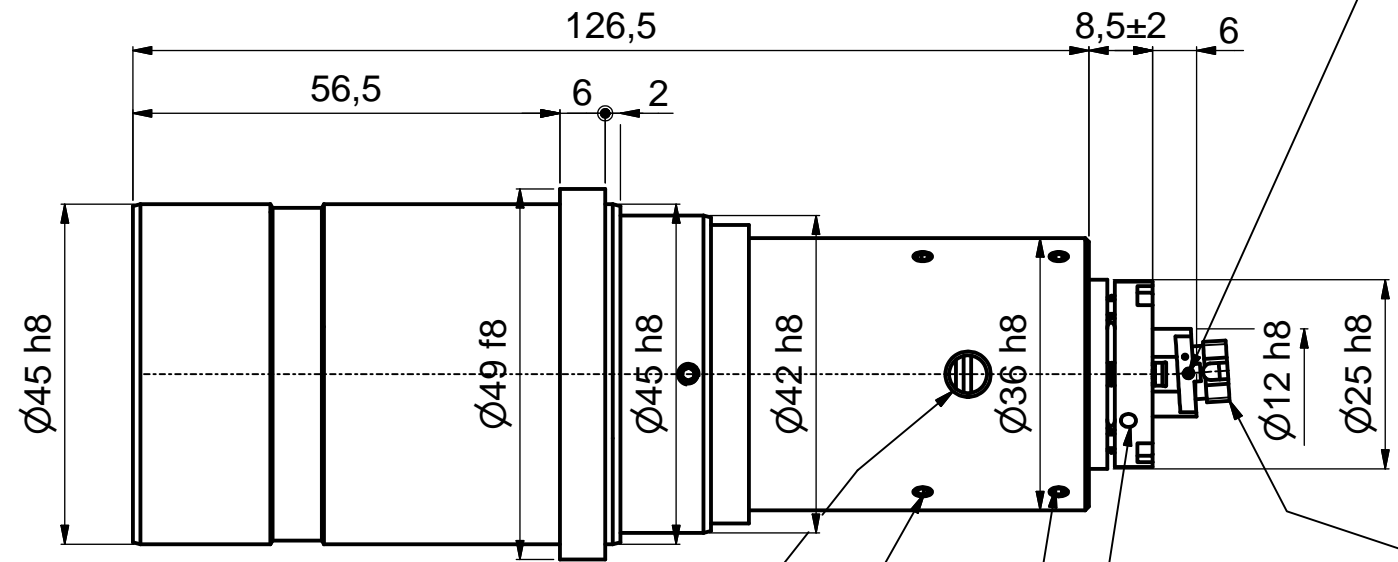

Fiber receptacle  
type FC-APC

adjustment of focus setting  
using eccentric-key 55EX-5 ③

Stop screw (2x/3x120°) for locking  
optics position  
using hex key 1.5mm  
50HD-15 ①

Stop screw (2x120°) for lock/unlock  
of the rotation of the  
quarter wave plate  
with screw driver 1.2mm 9D-12 ②

! Don't touch any other screws !

Tools for assembly and adjustment

hex-key size 1.5mm 50HD-15 ①  
screw driver size 1.2mm 9D-12 ②  
eccentric-key 55EX-5 ③  
Adjustment key 60Z-2303 ④

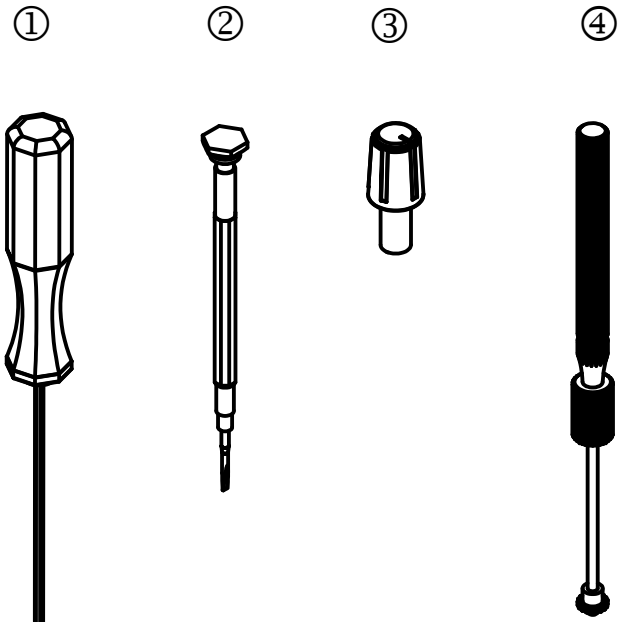

		Allgemeintoleranz ISO 2768 - f	Maßstab: 2:1
		60FC-Q-4-M125-xx	
		<b>60FC-Q-4-M125-xx</b>	
		Fiber receptacle type FC-APC	
		9802-4150-0017	
		Blatt A3	
		Blatt: 1	
Zust.	Änderungen	Datum	Name
		Datei: 980241500017.idw	Model: 980241500017.iam