

Thrust and tension screw (3x120°)
for tilt adjustment
with hex key wrench size 1.5mm
50HD-15 ①

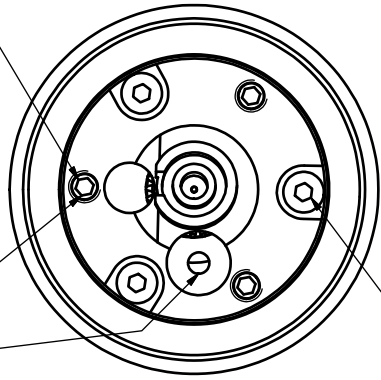

Rotation of the quarter wave plate
with adjustment key ④

Thrust screw M3 max.torque 50Ncm

Tension screw M2 max.torque 40Ncm

hex-key size 1.5mm 50HD-15 screw driver size 1.2mm 9D-12 eccentric-key 55EX-5 Adjustment key 60Z-2303

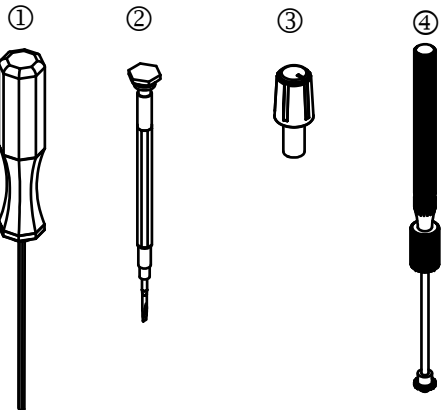

! Pin screw for additional locking of the fiber ferrule:
- before pulling the FC-connector:
unlock the pin screw.
- before inserting the FC-connector:
make sure the ferrule receptacle is not blocked
by the pin screw !

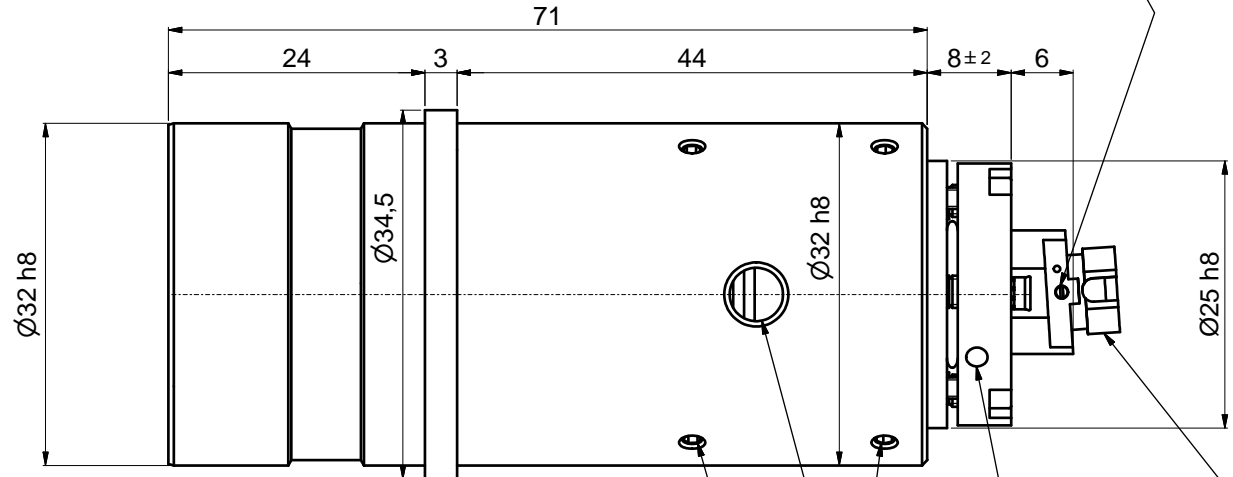

clamp screws for locking optics position (3x120°)
using hex-key size 1.5mm ①
50HD-15

adjustment of focus setting
using eccentric-key 55EX-5 ③

Fiber receptacle
type FC-APC

Stop screw (2x120°) for lock/unlock
of the rotation of the
quarter wave plate
with screw driver 1.2mm 9D-12 ②

! Don't touch any other screws !



Allgemeintoleranz ISO 2768 - f		Maßstab: 2:1	
60FC-Q-4-M75-xx		60FC-Q-4-M75-xx	
60FC-Q-4-M75-xx		60FC-Q-4-M75-xx	
Fiber receptacle type FC-APC		Fiber receptacle type FC-APC	
Schäfter&Kirchhoff OPTO-SENSORIK UND MESSTECHNIK OPTIK-ENTWICKLUNG/ELEKTRONIK/SORTIERTECHNIK/SOFTWARE		Blatt A3	
9802-4186-3300		Blatt 2	
Zust.	Änderungen	Datum	Name
Datei: 980241863300.idw		Modell: 980241863300.iam	