

! Pin screw for additional locking of the fiber ferrule:  
 - before pulling the FC-connector:  
 unlock the pin screw.  
 - before inserting the FC-connector:  
 make sure the ferrule receptacle is not blocked  
 by the pin screw !

Thrust and tension screw (3x120°)  
 for tilt adjustment  
 with hex key wrench size 1.5mm  
 50HD-15 ①

clamp screws  
 for accessory optics (3x120°)  
 using hex-key size 1.5mm  
 50HD-15 ①

Thrust screw M3 max.torque 50Ncm

Tension screw M2 max.torque 40Ncm

clamp screws for locking optics position (2x120°)  
 using hex-key size 1.5mm  
 50HD-15 ①

adjustment of focus setting  
 using eccentric-key 55EX-5 ③

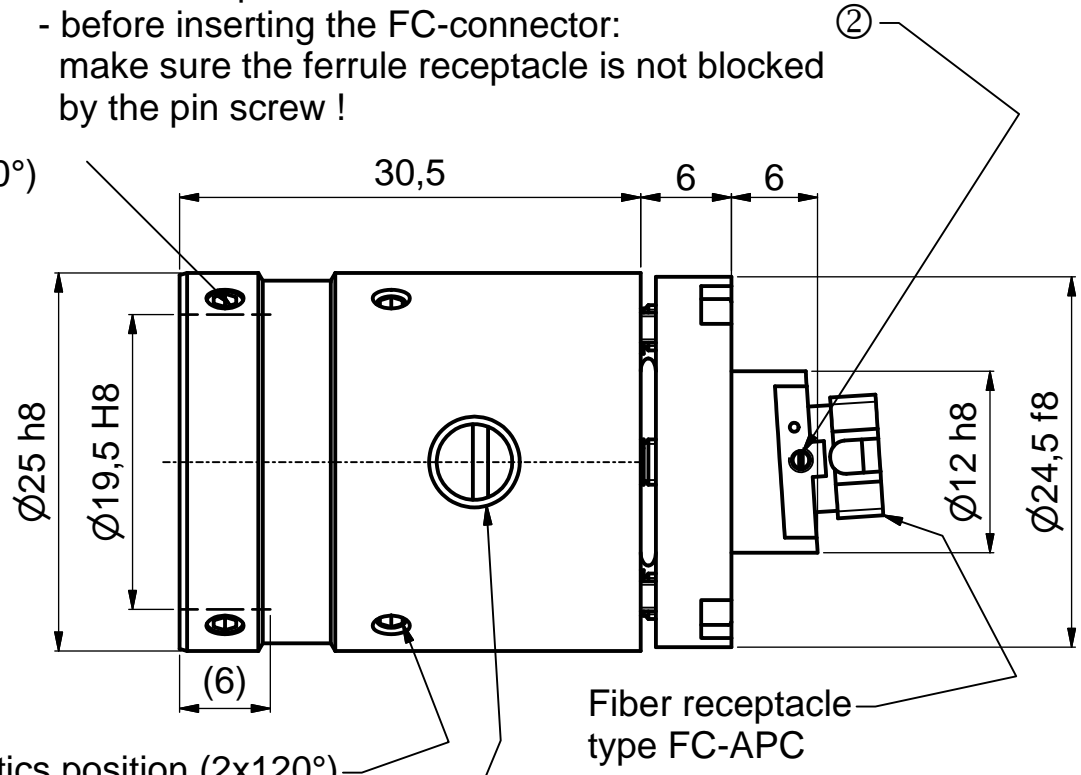

! Don't touch any other screws !

Tools for assembly and adjustment

- hex-key size 1.5mm 50HD-15 ①
- screw driver size 1.2mm 9D-12 ②
- eccentric-key 55EX-5 ③

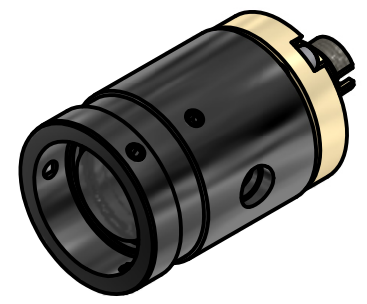
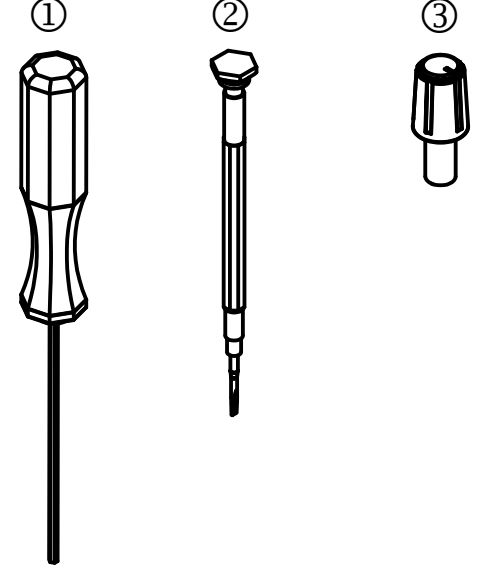

Allgemeintoleranz ISO 2768 - f		Maßstab: 2:1	
60FC-T-4-M20L-xx		60FC-T-4-M25-xx	
60FC-T-4-M30-01/02/03/04			
	Datum	Name	
Bearb.	29.07.2015	Tp	
Gepr.			
Norm			
<b>Fiber collimator f'20-30mm</b>			
Fiber receptacle type FC-APC			
Schäfter&Kirchhoff OPTO-SENSORIK UND MESSTECHNIK <small>OPTIK-ENTWICKLUNG-ELEKTRONIK-SENSORTECHNIK-SOFTWARE</small>			Blatt A3
Datei: 980312235200.idw			Blatt: 2
Zust.	Änderungen	Datum	Name
Datei: 980312235200.idw		Modell: 980312235200.iam	