

48MC-MP-19.5

Mounting plate for the Schäfter+Kirchhoff multicube™ system



FEATURES

Mounting plate for the Schäfter+Kirchhoff multicube™ system.
For integration of components with Ø 19.5 mm system mount such as [60SMS](#) Laser Beam Couplers.
Direct attachment to post mounts using the M4 thread.

DESCRIPTION

Mounting plate for the Schäfter+Kirchhoff multicube™ system.

For integration of components with Ø 19.5 mm system mount such as 60SMS Laser Beam Couplers.

Direct attachment to post mounts using the M4 thread.

TECHNICAL DATA

48MC-MP-19.5

Order Code	48MC-MP-19.5
Dimensions	42 x 42 x 12 mm
Fitting bore	Ø 19.5 mm
Material	Black anodized aluminum
Weight	39.5 g

Dimensions (for a complete dimensional drawing please refer to the downloads section)

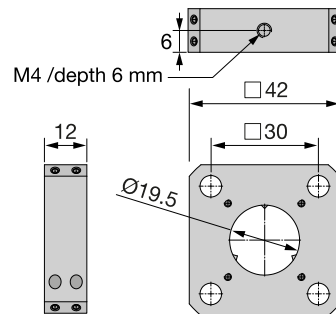

TECHNOTES

- [Multicube Compatability](#)
[Compatability to other cage systems](#)

FAQ

Compatability of the multicube system

Is my system compatible to established 30 mm cage systems or microbench systems?

The multicube components of series 48 have a rod hole distance of 30 mm. You can attach systems based on those components easily to a 30 mm cage systems or microbench system. More informaion can be found [here](#).

If you are working with a system based on series 68, there are adapters available, so that they can be used with 30 mm cage systems as well.

Is my system compatible to established 60 mm cage systems?

The multicube components of series 68 have a rod hole distance of 60 mm. You can attach systems based on those components easily to a 60 mm cage systems or microbench system. More informaion can be found [here](#).

If you are working with a system based on series 48, there are adapters available, so that they can be used with 60 mm cage systems as well.

DOWNLOADS



[980910330301_kuz.pdf \(Dimensional drawing\)](#)

RELATED PRODUCTS

**48MC MOUNTING
PLATES**

Base unit for multicube™ system. Compatible with established cage and microbech systems

**MULTICUBE
COMPONENTS**

Multicube Components like mounting plates, cubes etc.

This is a printout of the page https://sukhamburg.com/products/details/48MC-MP-19_5 from 5/10/2024

CONTACT

For more information please contact:

Schäfter + Kirchhoff GmbH

Kieler Str. 212

22525 Hamburg

Germany

Tel: +49 40 85 39 97-0

Fax: +49 40 85 39 97-79

info@sukhamburg.de

www.sukhamburg.com

LEGAL NOTICE

Copyright 2020 Schäfter+Kirchhoff GmbH. All rights reserved.

Text, image, graphic, sound, video and animation files and their arrangement on Schäfter+Kirchhoff GmbH webpages are protected by copyright and other protective laws. The content may not be copied for commercial use or reproduced, modified or used on other websites. [\[more\]](#)